

PROJECT NO.		YEAR	SHEET NO.
BR-1-24-2(184)		2025	1
REVISIONS			
NO.	DATE	BY	BRIEF DESCRIPTION

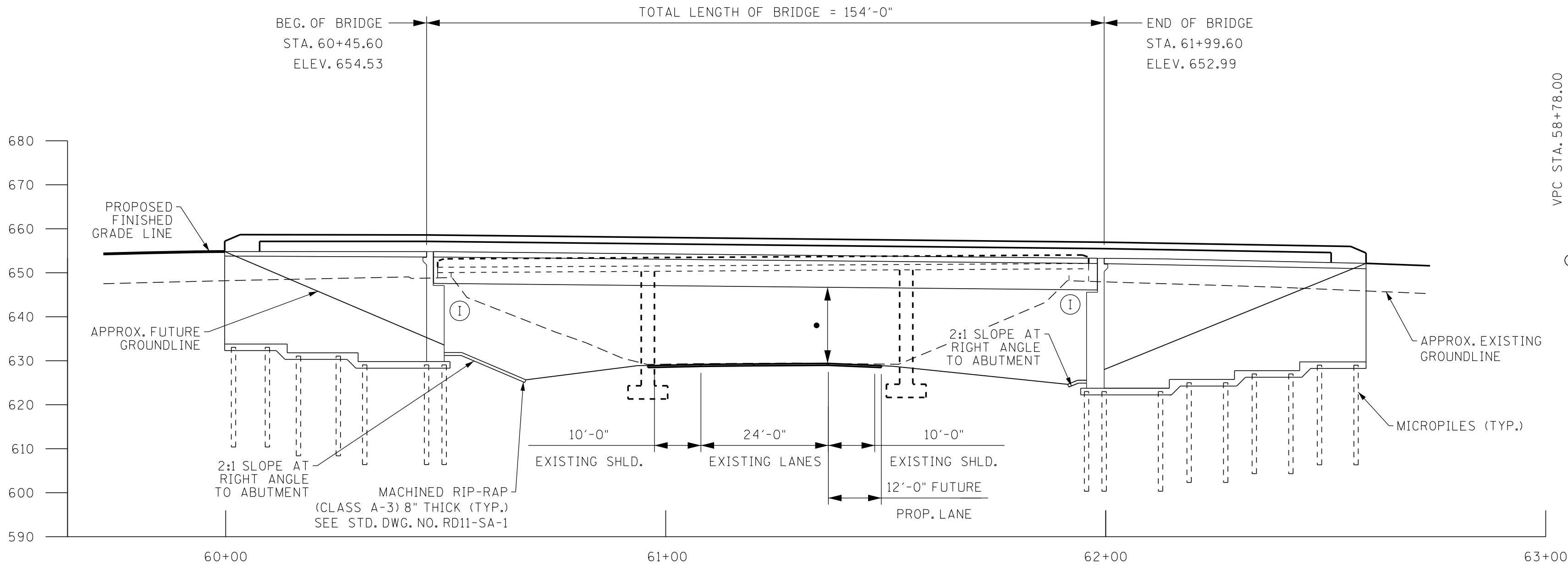

• DENOTES: MIN. VERT. CLEARANCE:
REQUIRED: 16'-0"
ACTUAL: 16'-6"

① DENOTES: INTEGRAL

ELEVATION

SCALE: 1" = 20'-0"

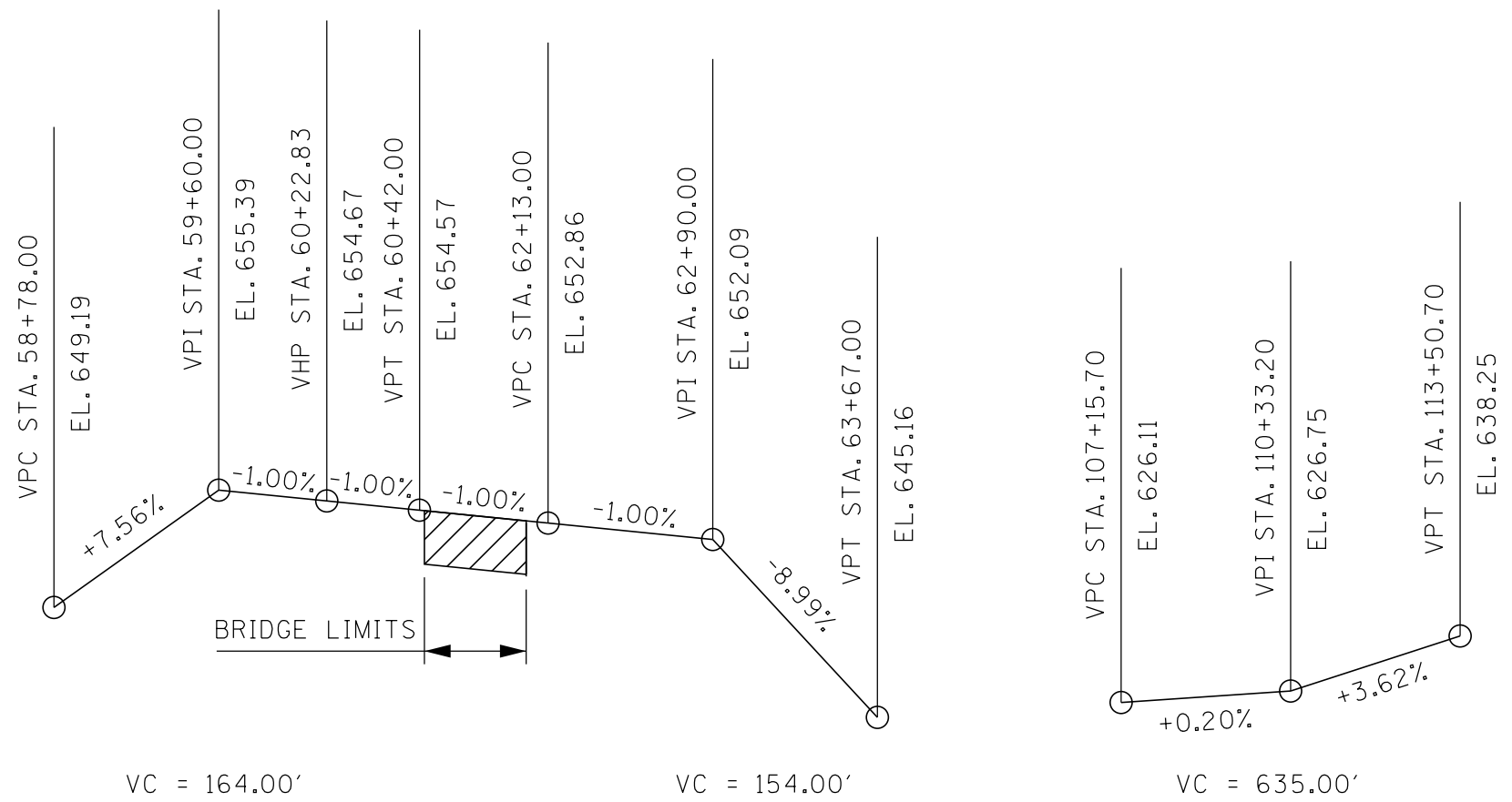

GRADE SKETCH

(SHELLMOUND RD.)

GRADE SKETCH

(I-24 EB)

GENERAL NOTES

- CONSTRUCTION SPECIFICATIONS: TENNESSEE DEPARTMENT OF TRANSPORTATION STANDARD SPECIFICATIONS FOR ROAD AND BRIDGE CONSTRUCTION (JANUARY 1, 2021 EDITION.)
- DESIGN SPECIFICATIONS: 10TH EDITION (2024) AASHTO LRFD BRIDGE DESIGN SPECIFICATIONS AND THE (2011) AASHTO GUIDE SPECIFICATIONS FOR LRFD SEISMIC BRIDGE DESIGN, EDITION 2, WITH INTERIMS.
- LOADING: HL-93 LIVE LOAD INCREASED BY 10% (MULTIPLIED BY 1.1) IN ADDITION TO ALL LOAD FACTORS SPECIFIED BY AASHTO FOR ALL APPLICABLE LOAD COMBINATIONS; SEISMIC CATEGORY "C" WITH $A_s = 0.139$, $S_w = 0.272$, $S_e = 0.068$ (1000 YEAR RETURN PERIOD); DEAD LOADS SHALL INCLUDE 35 LB/SQ. FT. FOR FUTURE WEARING SURFACE.
- SUPERSTRUCTURE: TO CONSIST OF 1 SPAN OF BT-72 BEAMS WITH COMPOSITE CONCRETE SLAB.
- CONCRETE: CLASS A $F'C = 3000$ PSI, CLASS D $F'C = 4000$ PSI FOR BRIDGE DECK.
- REINFORCING STEEL: TO BE ASTM A615 GRADE 60 UNLESS NOTED OTHERWISE. EPOXY COAT ALL SLAB STEEL.
- BRIDGE DECK SURFACE FINISH: TO BE IN ACCORDANCE WITH METHOD 3 IN ARTICLE 604.22 OF THE STANDARD SPECIFICATIONS.
- USE STD-1-1SS FOR PARAPETS.
- TEXTURE COATING: TO BE GRAY (36440) EXCEPT TRAFFIC FACE AND TOP OF PARAPET TO BE WHITE (37886).
- EXCAVATION: TO BE BASED ON FINAL PROFILE AT ABUTMENTS.
- REMOVE EXISTING BRIDGE NO. 581002400392 AND APPROACHES TO NATURAL GROUND LINE BETWEEN STATIONS 60+51.29+- AND 61+90.75+- IN ACCORDANCE WITH SECTION 202.04 OF THE STANDARD SPECIFICATIONS.
- EXISTING BRIDGE DESCRIPTION: 139.5' LONG, 3-SPAN CONCRETE BEAM, CONCRETE DECK.

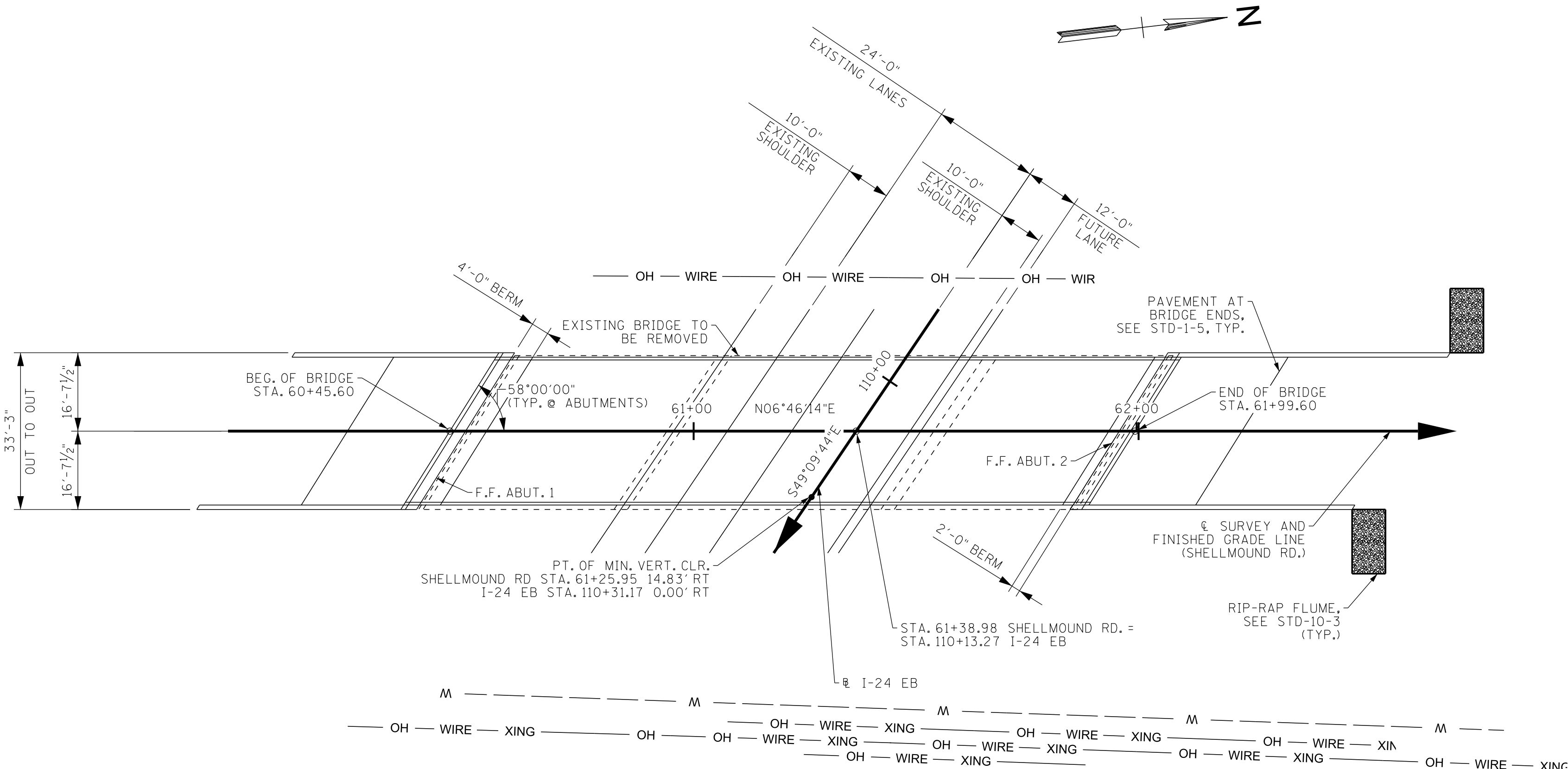

PLAN

SCALE: 1" = 20'-0"

DESIGN SPEED = 30 MPH
2046 ADT = 1,930
ROADWAY WIDTH = 32'-0"
STD-1-1SS PARAPET

STATE OF TENNESSEE
DEPARTMENT OF TRANSPORTATION

BRIDGE NO. 130902
PRELIMINARY LAYOUT
BRIDGE ID. NO. 58100240039
SHELLMOUND RD.
OVER I-24 EB
STA. 61+36.98
MARION COUNTY
2025

DESIGNED BY _____ ARCADIS _____ DATE 5/2025
DRAWN BY _____ C. McGRAW _____ DATE 5/2025
SUPERVISED BY _____ G. HOOVER _____ DATE 5/2025
CHECKED BY _____ B. WATSON _____ DATE 5/2025

P.E. NO. _____

PROJECT NO.		YE - R	SHEET NO.
BR-1-24-2 (184)		2025	2
REVISIONS			
NO.	D-TE	BY	BRIEF DESCRIPTION

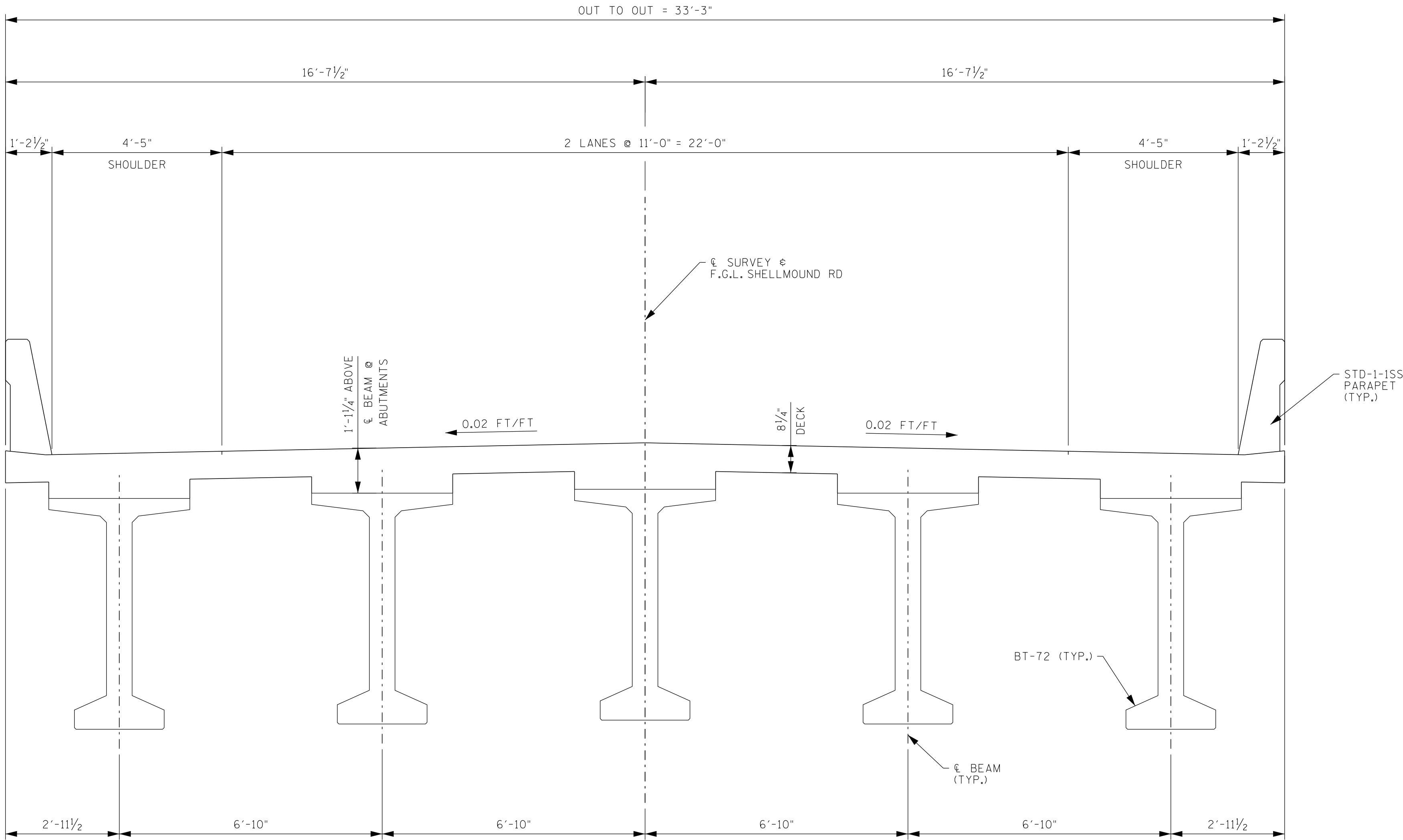

TYPICAL SECTION

DESIGNED BY _____ ARCADIS _____ D-TE 5/2025
DR-WN BY _____ C. McGRAW _____ D-TE 5/2025
SUPERVISED BY _____ G. HOOVER _____ D-TE 5/2025
CHECKED BY _____ B. WATSON _____ D-TE 5/2025

STATE OF TENNESSEE
DEPARTMENT OF TRANSPORTATION
BRIDGE NO. 130902
PRELIMINARY LAYOUT
BRIDGE ID. NO. 58100240039
SHELLMOUND RD.
OVER I-24 EB
STA. 61+36.98
MARION COUNTY
2025